

Installation instructions

Layout P1615 - Glazing Bead Mounts

Congratulations!
on the purchase of your pleated blinds from Window Fashion.

These blinds have been custom-made in Germany, using only high-quality materials to your precise specifications.

Please follow the installation and care instructions given below to ensure an excellent fit and a long life for your pleated blinds.

We wish you every enjoyment and success with your new blinds.

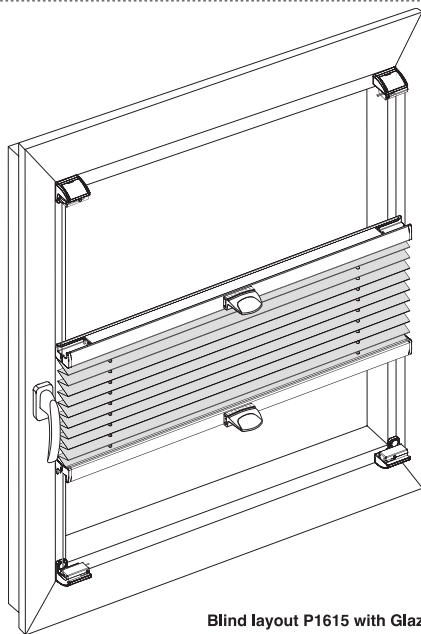

Blind layout P1615 with Glazing Bead Mounts

Positioning on the glazing bead

The outside edges of the blind align with those of the Glazing Bead Mounts.

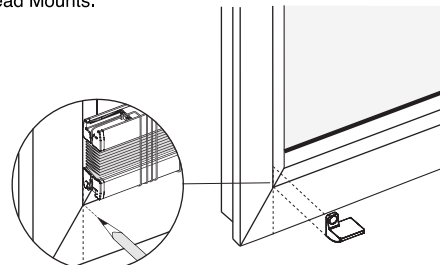

Installation of Glazing Bead Mounts

① Glazing Bead bracket upper

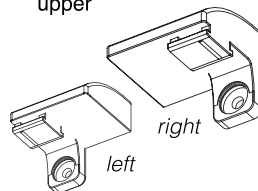

②

Tighten screws carefully by hand

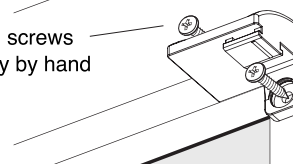

③ Separate end covers

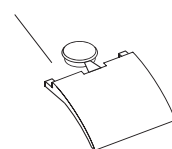

④

Fit end covers and slide bracing platelet into position

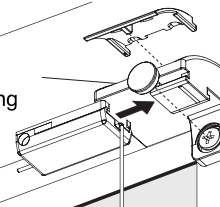

① Glazing Bead bracket lower

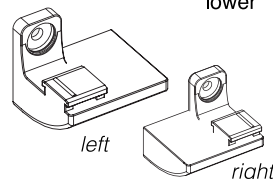

②

Tighten screws carefully by hand

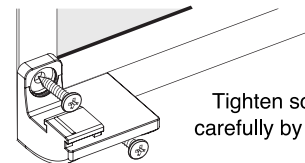

③ Separate end covers

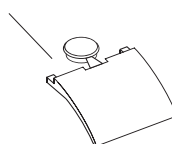

④

Fit end covers and slide bracing platelet into position

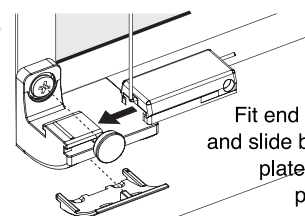

Fitting the blind

Remove rubber bands. Unwind cord including bracing platelet.

Attach upper bracing platelets first.

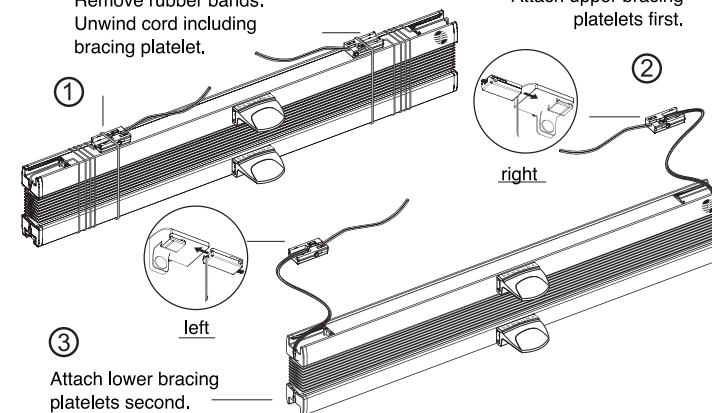

Blind operation

Use the operating handles to raise and lower the braced cordless blind.

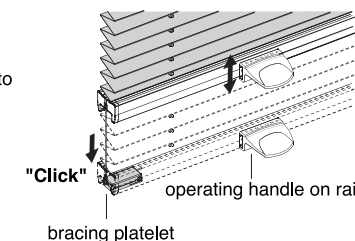

After performing a function check, the overhanging cords can be cut off.

Adjusting blind tension

To adjust the tension of the blind, remove the blind from the window. Loosen the screws in the lower bracing platelets with the supplied allen key and adjust the length of the tension cords equally on both sides (a pencil mark on the cords may help). Tighten the screws and re-fit the blind to the window.

Contents:

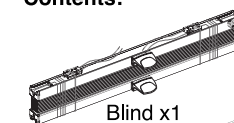

Blind x1

Screws x8
(2.9 x 9.5 mm)

Allen key (M3) x1



Glazing Bead brackets with end covers 4x

Please read the following advice carefully prior to installation

Improper installation can cause injury. Blind must be installed according to instructions, using the supplied components.